



## Installing the Fold&Slide sashes

### NOTE

As a prerequisite for installing the Fold&Slide sashes, the Fold&Slide sash with frame hinges on the frame side must already be installed and correctly adjusted (for more information see the corresponding profile-specific installation drawing for Turn-Only or Tilt&Turn hardware).

### How to install a Fold&slide sash

- Attach the Fold&Slide sash to be mounted to the sash that is already installed and push the hinges into one another.
- Insert the pins into the three sash hinges from above or from below, depending on the installation position of the sash hinges (see illustration on right). The pins must noticeably engage.

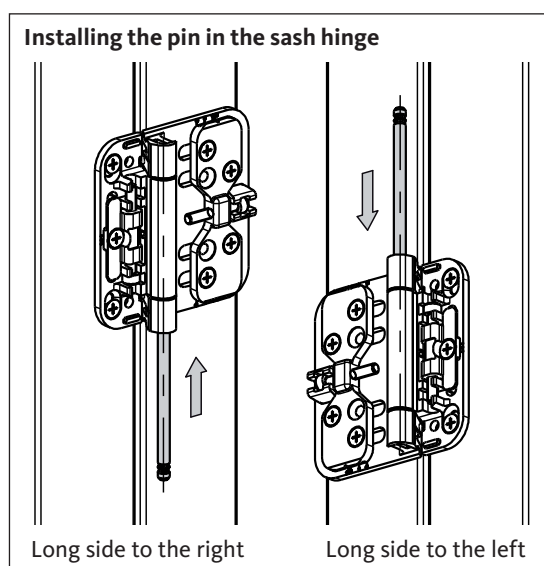

- Push the lower pivot-rest of the Fold&Slide sash to be installed onto the bogie (1).
- Tighten the locknut of the bogie with the open-end spanner (size 17) to prevent the Fold&Slide sash from slipping out (2).

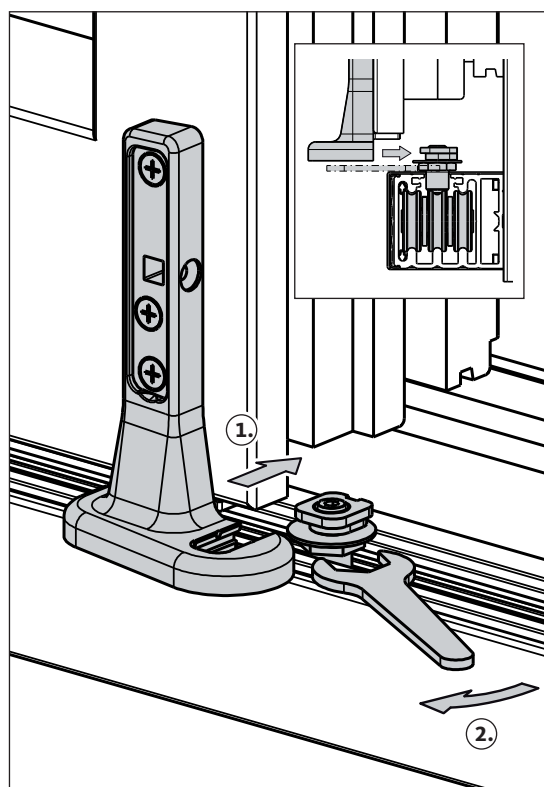

- Push the upper pivot-rest of the Fold&Slide sash to be installed onto the guide roll (1).
- Tighten the locknut on the guide roll with the open-end spanner (size 17) to prevent the Fold&Slide sash from slipping out (2).

**NOTE**

Depending on the size of the sashes, the upper pivot-rest can be inserted more easily with the sashes open.

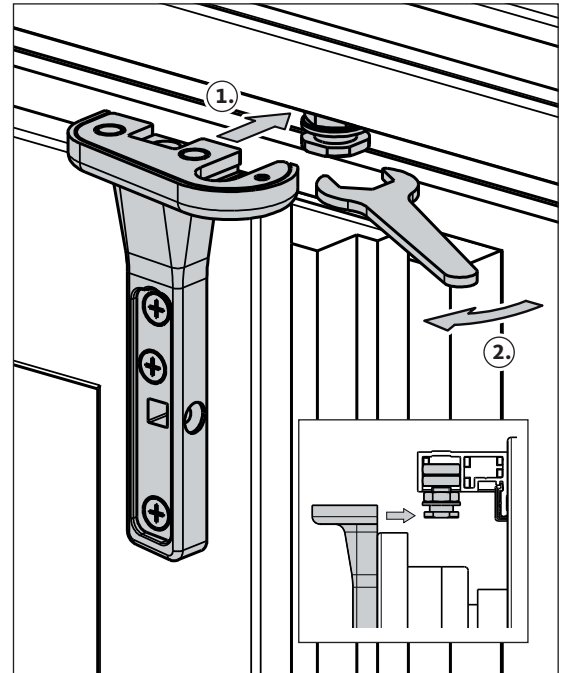

**NOTE**

After each individual Fold&Slide sash is installed, the gap between the threshold and frame rebate must be adjusted.

The procedure for adjusting the gap is explained in chapter "Adjusting the bogie and guide roll" on page 3.

**NOTE**

After installing each individual Fold&Slide sash, check the frame hinges of the first Fold&Slide sash and readjust if necessary.



## Adjusting the Fold&Slide hardware Adjusting the bogie and guide roll

The gap between the threshold and frame rebate and the gasket pressure of a Fold&Slide sash can be adjusted at the bogie and guide roll. Please proceed as follows:

- Move the Fold&Slide sash that is already installed carefully into the closed position.
- Undo the locknut of the bogie on the Fold&Slide sash to be adjusted using the open-end spanner (size 17)
- Adjust the gap between the threshold and frame rebate by turning the set screw with a hexagon spanner (size 4) so it corresponds to the dimension specified in the installation drawing for the specific profile (the set screw can be adjusted from  $-1$  mm to  $+3.5$  mm).
- Adjust the gasket pressure by sliding the pivot-rest.
- Then tighten the locknut again with the open-end spanner (size 17) (tightening torque: 15 Nm).
- Undo the locknut on the guide roll of the Slide&Fold sash to be adjusted using the open-end spanner (size 17).
- Adjust the height of the guide roll by turning the set screw with a hexagon spanner (size 4) so the guide roll cannot scrape against the guide track (adjustment range  $-1$  mm to  $+3.5$  mm).
- Adjust the gasket pressure by sliding the pivot-rest.
- Then tighten the locknut again with the open-end spanner (size 17) (tightening torque: 15 Nm).

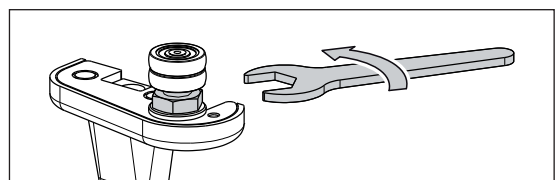
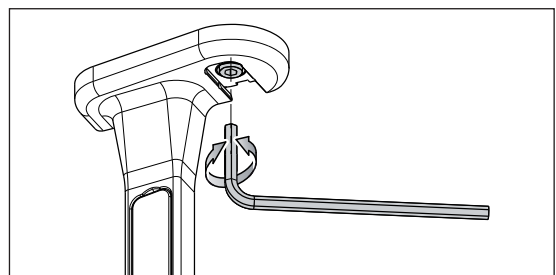
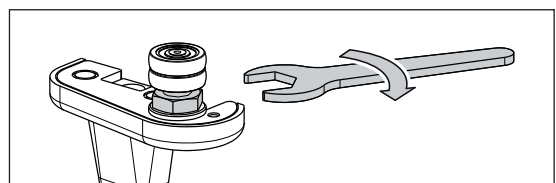
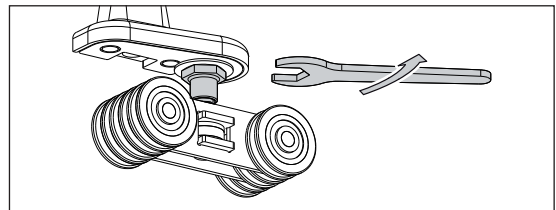
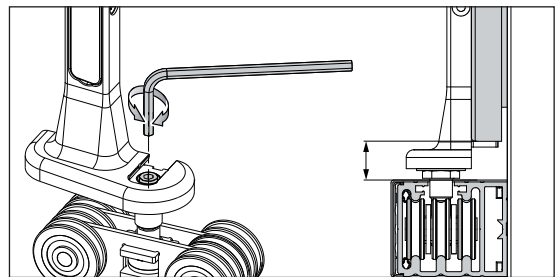
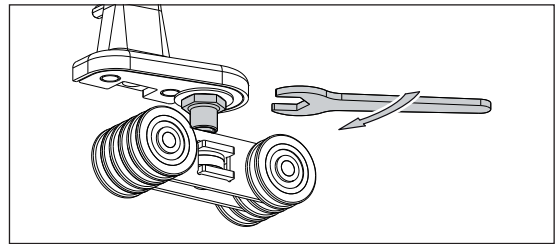

## Adjusting the sash hinges

The vertical position of the Fold&Slide sashes relative to one another and the size of the shadow gap between the sashes can be adjusted at the hinges.

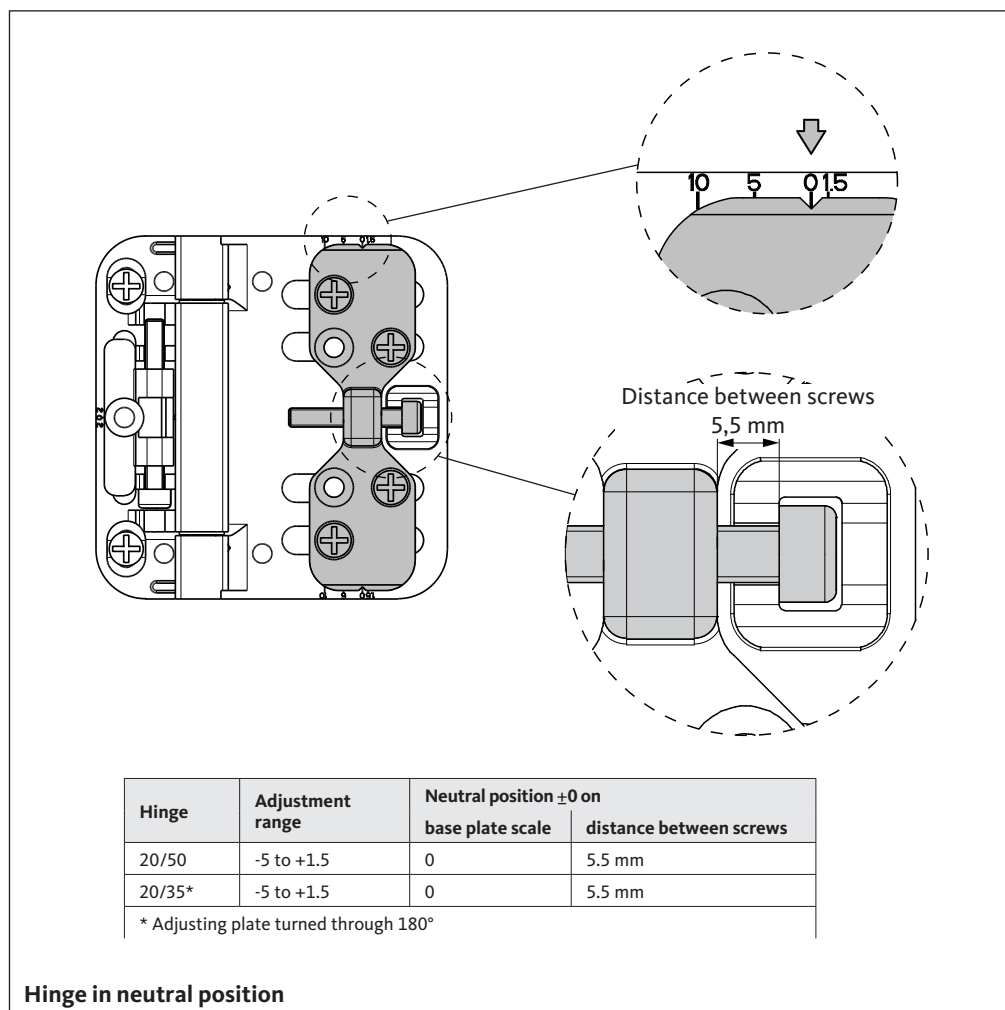

You can adjust the vertical position of the Fold&Slide sashes relative to one another and also the shadow gap between the sashes when installed by turning the set screws at the hinge (see figure "Adjustment of the hinge" on page 5):

### ATTENTION

Always make the adjustments at the set screws **1** and **2** one by one!

If you undo all screws at once, this could damage the sash hinge!

#### Aligning the Fold&Slide sash vertically by turning the set screw **1**

To align the Fold&Slide sashes vertically, proceed as follows:

- Slightly loosen the two screws **1a** so that the hinge and sash **1** can move relative to one another.
- Adjust the vertical position of the sliding panel by turning the set screw **1**.
- Tighten the two screws **1a** again.



## Adjusting the shadow gap via the set screw 2

To adjust the shadow gap between the Fold&Slide sashes, proceed as follows:

- Slightly loosen the four screws 2a so that the hinge and sash 2 can move relative to one another.
- Adjust the shadow gap by turning the set screw 2.
- Tighten the two screws 2a again.

### Adjustment of the hinge

Long side of the hinge on the right

Set screw 1		
Rotational direction of set screw	Direction of movement of sash 2	Max. adjustment range
RH (clockwise)	upwards	+2
Left (counter-clockwise)	downward	-2

Set screw 2		
Rotational direction of set screw	Direction of movement of sash 2	Max. adjustment range
right (clockwise)	to the right (shadow gap increases)	+1,5
Left (counter-clockwise)	to the left (shadow gap decreases)	-5

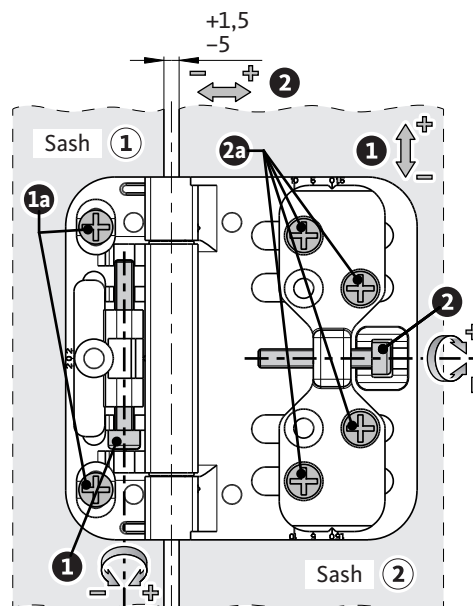

Long side of hinge on left

Set screw 1		
Rotational direction of set screw	Direction of movement of sash 2	Max. adjustment range
RH (clockwise)	downward	-2
Left (counter-clockwise)	upwards	+2

Set screw 2		
Rotational direction of set screw	Direction of movement of sash 2	Max. adjustment range
right (clockwise)	to the left (shadow gap increases)	+1,5
Left (counter-clockwise)	to the right (shadow gap decreases)	-5

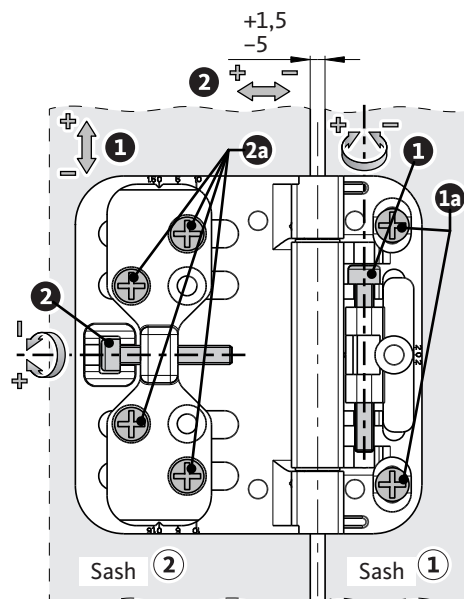

## Checking the setting of the hinges

### NOTE

Each time you adjust the hinges, check afterwards that they are uniformly aligned!

Please proceed as follows:

- Make sure that the test dimension shown in the figure below is identical at all three hinges of the sash.

If this is not the case, adjust the height of the Fold&Slide sashes relative to one another again at the set screw **1** until all three test dimensions are exactly the same.

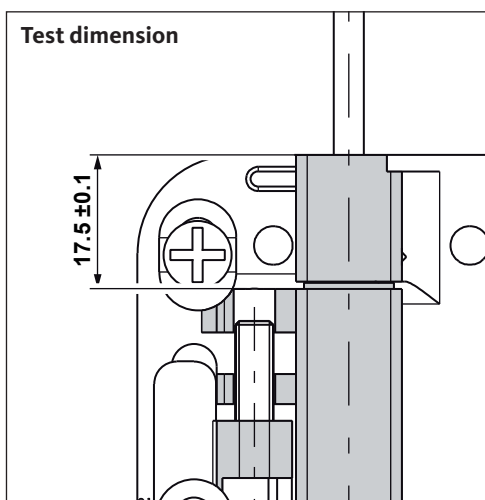

- Make sure, using a straight edge or a long spirit level, that the lateral edges of the long sides of all three hinges on the sash are flush.

If one of the hinges does not line up with the other two, turn the adjusting screw **2** until it does.

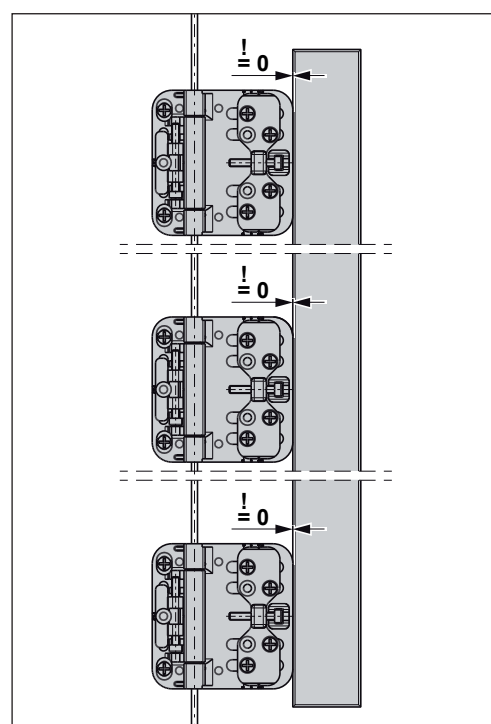
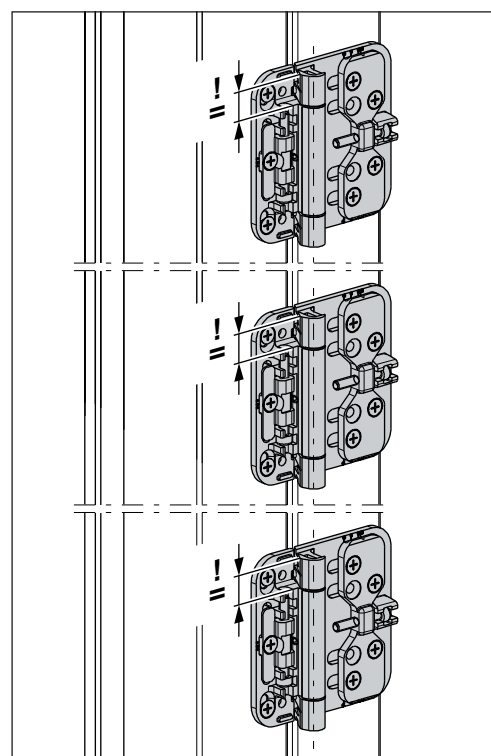



## Adjusting the gasket pressure

You can increase or reduce the gasket pressure using a Torx wrench T15, as shown below.

- Adjusting the gasket pressure at the upper locking point on the locking side (at the sash).

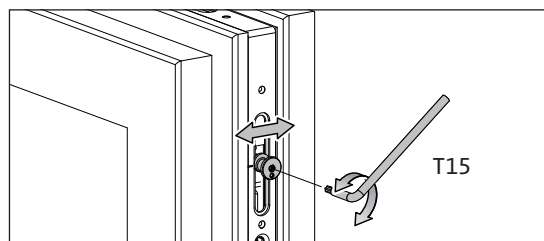

- Adjusting the gasket pressure at other locking points on the underside of the sash.

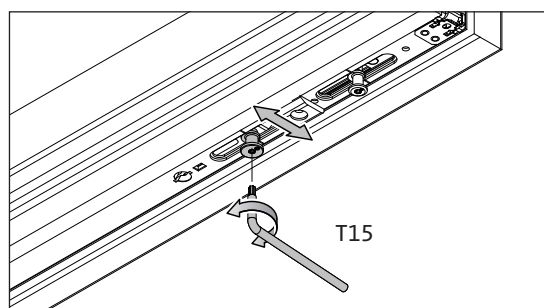

- Adjusting the gasket pressure at the side of the sash at the top.

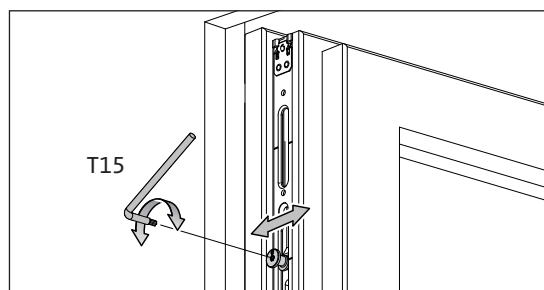

## Installing the cover

### NOTE

It is advisable to adjust the Fold&Slide system before mounting the cover. Also see chapter "Adjusting the Fold&Slide hardware" on page 3.

### Installing the cover of the pivot-rest

- Plug the long cover onto the pivot-rest (1.).
- Fasten the long cover by screwing in the screw provided (2.) from the side.
- Push the small cover at the bottom into the pivot-rest until it snaps into place (3.).

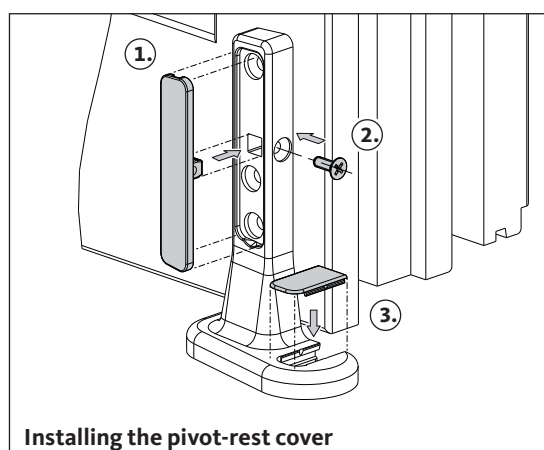

Installing the pivot-rest cover

## Installing the hinge cover

- Open the Fold&Slide system so the sashes are at roughly 90° to one another.  
This allows the set screws of the hinges to be accessed from the side opposite to the hinges.
- Push the large cover from the hinge side completely onto the hinge.

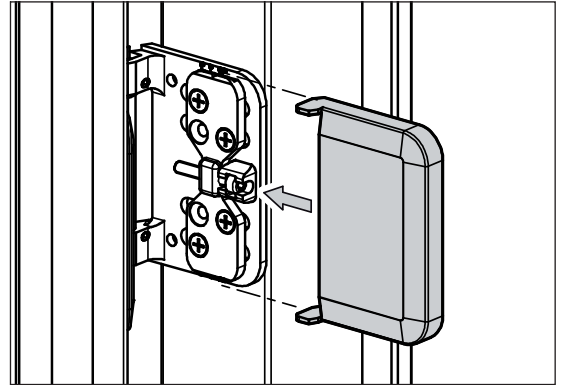

- To fasten the cover to the hinge, screw in the two set screws (see illustration) completely by turning them clockwise with a hexagon spanner.

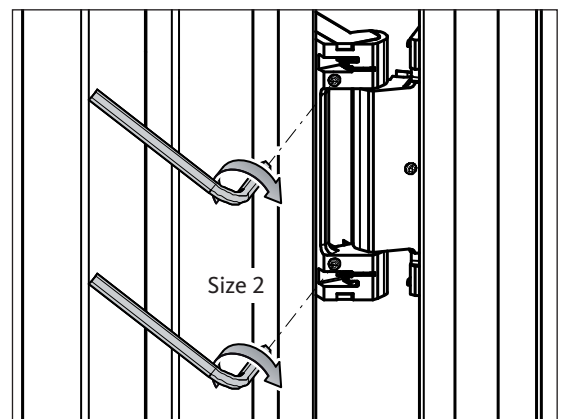

- Push the small cover completely onto the hinge from the hinge side.

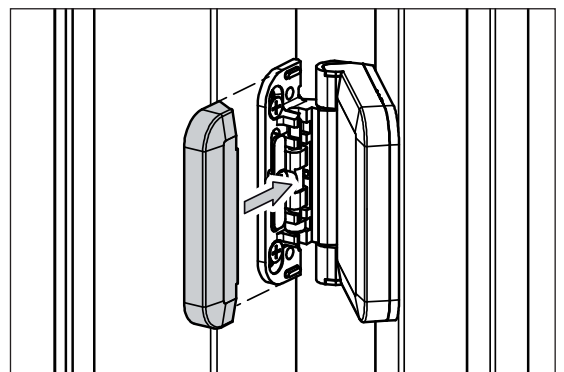

- To fasten the cover to the hinge, screw in the set screw (see illustration) completely by turning it clockwise with a hexagon spanner.

